

RV-3032-C7

RTC module I²C bus High Accuracy

- Ultra low power consumption 160nA @ 3V
- Excellent time accuracy $\pm 2.5\text{ppm}$ -40 to +85°C
- 12-bit temperature sensor accuracy $\pm 1^\circ\text{C}$ typical
- Timestamped external event input detection with interrupt
- Trickle Charger with charge pump

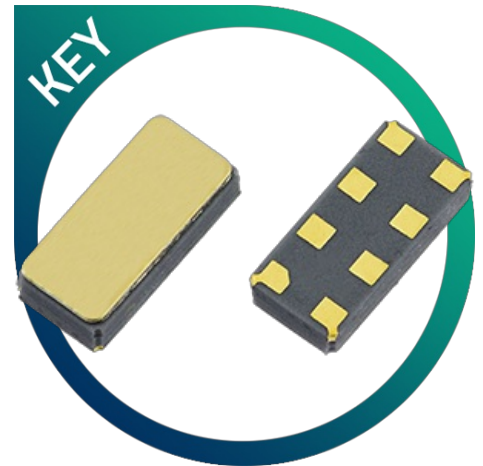

CONFIGURABLE OPTIONS

Parameter	Option Code
Qualification	
Any	
Commercial	
AEC-Q200 (Automotive)	A

SPECIFICATIONS

Frequency	32.768kHz
Dimensions	3.2 x 1.5 x 0.8mm
Time accuracy	±1.5ppm max (0.13s/day), 0+50°C ±2.5ppm max (0.216s/day), -40+85°C
Operating temperature range	-40 to +85°C
Storage temperature range	-55 to +125°C
Supply voltage (V _{DD})	1.2 ~ 5.5V
Supply current (time-keeping, V _{DD} =3.0V)	160nA typ / 210nA max
Ageing (25°C)	±3ppm max first year
Shock and vibration resistance	±5ppm, 5,000g, 0.3ms, ½ sine ±5ppm, 20g, 10.0 ~ 2,000Hz
Soldering condition	Reflow, 260°C, 20 sec max
Clock output frequencies (programmable)	32.768kHz, 1024Hz, 64Hz, 1Hz crystal mode 8192Hz ~ 52MHz HF clock mode
Net mass	11.4mg

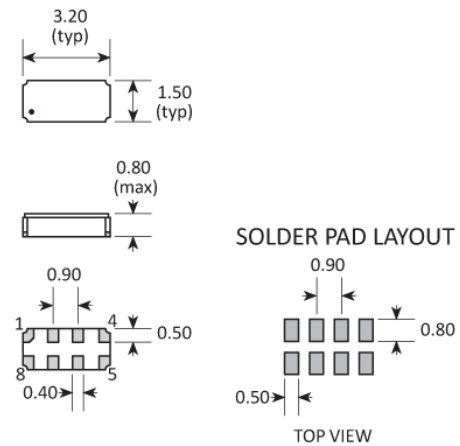
PACKAGE DRAWING

PAD	CONNECTION	PAD	CONNECTION
1	Backup supply (VBKP)	5	Ground (VSS)
2	Serial data (SDA)	6	Supply voltage (VDD)
3	Interrupt output ($\overline{\text{INT}}$)	7	Frequency output (CLKOUT)
4	Event Input (EVI)	8	Serial clock input (SCL)

Dimensions in mm

ORDERING INFORMATION

To request a quotation for the RV-3032-C7 please use the configurable options form to choose the options you require and then submit your configured product to our team. Our expert advisers are always happy to help with your requirements and can be contacted on +44 1460 256 100 or at sales@golledge.com.

Once we've received your request our expert team will then produce a quotation tailored to meet your needs using the option codes you've selected.

Following product selection you will be issued with a seven character Golledge part number. Your Golledge part number is the internationally accepted Golledge manufacturing part number (MPN) that should be used for all project documentation, including bills of materials (BoMs) and purchase orders.

If you have any queries regarding any of our documentation our dedicated sales team will be happy to help.

TECHNICAL RESOURCES

[RV-3032-C7_App-Manual.pdf](#)

TAPE & REEL SPECIFICATION

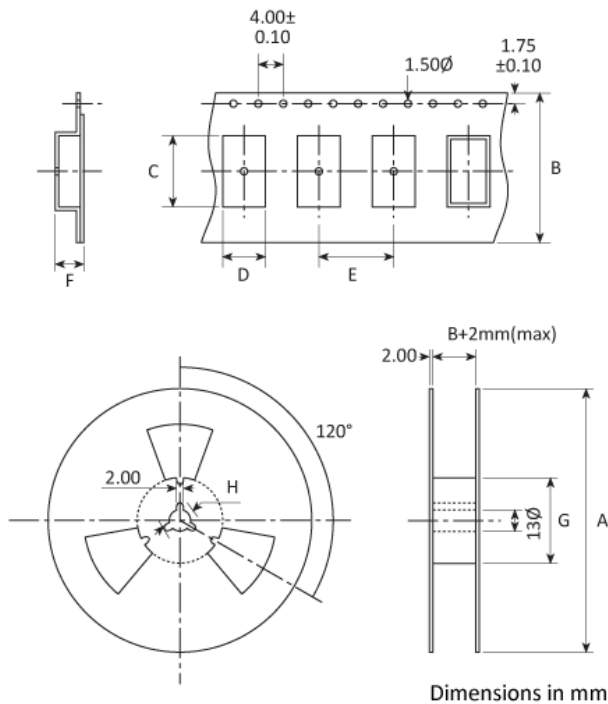

A:178* B:12 C:3.5 D:1.8 E:4.0 F:1.15 G:62 H:21

*Larger reel sizes are available

CONSTRUCTION

SON 8-pin ceramic package

HANDLING & STORAGE



Human Body Model (HBM) 1A (250V to <500V)



Moisture Sensitivity Level (MSL): 1 (or not applicable)

COMPLIANCE



Lead-free (< 0.1% by weight)



RoHS compliant with no exemptions. [See our declaration](#)



REACH compliant. [See our statement](#)



Free of conflict minerals. [See our declaration](#)



Free of Halogens. [See our declaration](#)



Free of Ozone-depleting substances. [See our declaration](#)

SUPPLY PARTNER

The RV-3032-C7 is manufactured by Micro Crystal and stocked and supplied by Golledge.

OTHER INFORMATION

An evaluation/development board for the RV-3032-C7 is also available on request. Please contact our expert advisers at sales@golledge.com for more information.

BLOCK DIAGRAM

