

# GSX49-3

## Low 3.2mm Profile Formed Lead SM Crystal



- Industry standard HC49 footprint
- Low profile case for close board stacking
- Wide frequency range
- Fundamental mode available up to 50.0MHz
- Low cost

### CONFIGURABLE OPTIONS

Parameter	Option Code
<b>Frequency</b>	
<b>Calibration tolerance</b>	
Any	
±20ppm	2
±30ppm	3
±50ppm	5
<b>Temperature stability</b>	
Any	
±30ppm	3
±50ppm	5
±100ppm	C
<b>Operating temperature range</b>	
Any	
-10 to +60 °C	1
-20 to +70 °C	2
-30 to +80 °C	3
-40 to +85 °C	4
<b>Circuit condition</b>	
Any	
12pF	B
16pF	D
18pF	E
20pF	F
30pF	J
<b>Oscillation mode</b>	
Any	
Fundamental	F
3rd overtone	3

## SPECIFICATIONS

Frequency range	3.579 ~ 90.0MHz
Dimensions	11.4 x 4.7 x 3.2mm
Package	HC49-3H SMD
Storage temperature range	-40 to +90°C
Equivalent series resistance	300Ω max (>3.1 ~ 3.5MHz) 150Ω max (>3.5 ~ 4.0MHz) 120Ω max (>4.0 ~ 4.4MHz) 100Ω max (>4.4 ~ 7.0MHz) 70Ω max (>7.0 ~ 10.0MHz) 50Ω max (>10.0 ~ 50.0MHz, fund) 100Ω max (>25.0 ~ 90.0MHz, 3rd OT)
Static capacitance (C <sub>0</sub> )	7pF max
Ageing	±3ppm max first year
Test drive level	100μW
Net mass	450mg

## PACKAGE DRAWING

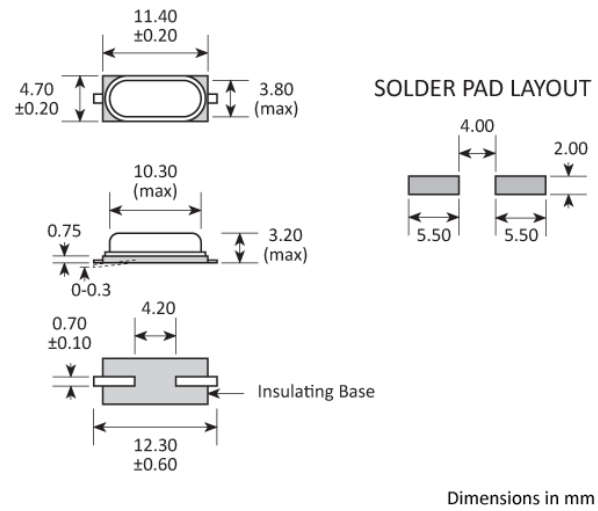

## ORDERING INFORMATION

To request a quotation for the GSX49-3 please use the configurable options form to choose the options you require and then submit your configured product to our team. Our expert advisers are always happy to help with your requirements and can be contacted on +44 1460 256 100 or at [sales@golledge.com](mailto:sales@golledge.com).

Following product selection you will be issued with a seven character Golledge part number. Your Golledge part number is the internationally accepted Golledge manufacturing part number (MPN) that should be used for all project documentation, including bills of materials (BoMs) and purchase orders.

If you have any queries regarding any of our documentation our dedicated sales team will be happy to help.

## MARKING

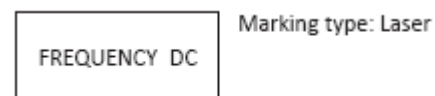

**SOLDERING PROFILE**

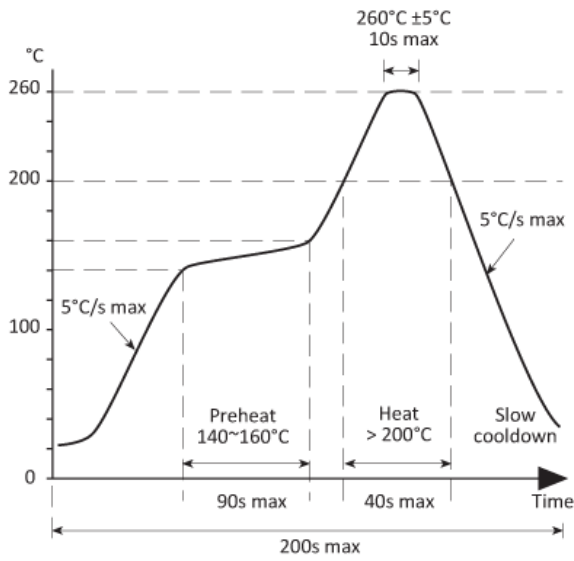

**TAPE & REEL SPECIFICATION**

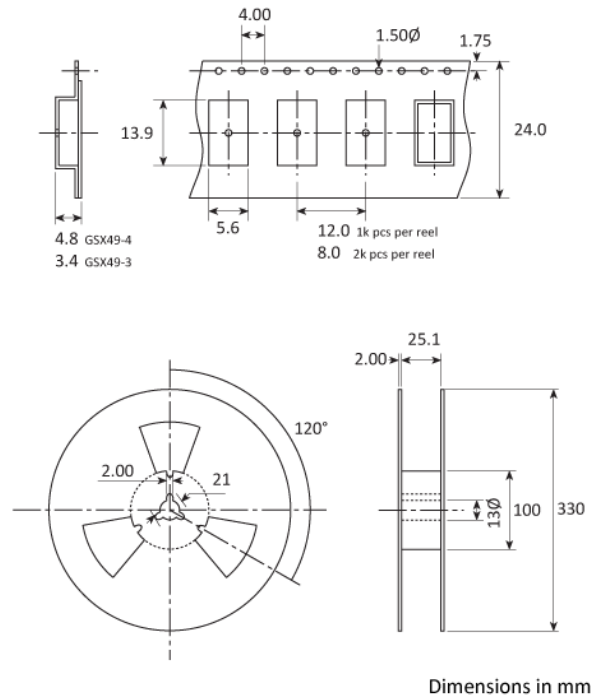

**HANDLING & STORAGE**



Human Body Model (HBM) 1A (250V to <500V)



Moisture Sensitivity Level (MSL): 1 (or not applicable)

**CONSTRUCTION**

Metal package, hermetic seal Insulating base, formed leads

## COMPLIANCE

---

Please refer to our **DOCUMENTS** section for more information.



Lead-free (< 0.1% by weight )



RoHS compliant with no exemptions.



REACH compliant.



Free of conflict minerals.



Free from halogens.



Free from ozone-depleting substances.