

456.0MHz SAW Filter

Model: TB0574A

Part No: MP01133

REV NO: 3

A. MAXIMUM RATING:

1. Operating Temperature: -40°C to +85°C
2. Storage Temperature: -40°C to +85°C
3. Maximum Input Power : 10dBm

B. ELECTRICAL CHARACTERISTICS:

1. Ambient Temperature: 25 °C

Item		Min.	Typical	Max.	
Center frequency	Fc	MHz	-	456.0	-
Insertion loss at Fc		dB	-	12.0	13.5
Bandwidth at -1.0dB		MHz	6.4	6.8	-
Bandwidth at -3.0dB		MHz	-	8.0	-
Amplitude Ripple (452.8 ~ 459.2 MHz)		dB	-	0.6	1.0
Amplitude Ripple (452.3 ~ 459.7 MHz)		dB	-	2.0	3.0
Group Delay Ripple (452.6 ~ 459.4 MHz)		nS	-	100	250
Attenuation (Reference level from minimum Insertion loss)					
1.0 ~ 256.0 MHz		dBc	30	64	-
256.0 ~ 360.0 MHz		dBc	45	56	-
360.0 ~ 420.0 MHz		dBc	45	47	-
420.0 ~ 449.3 MHz		dBc	35	41	-
462.7 ~ 492.0 MHz		dBc	35	39	-
492.0 ~ 552.0 MHz		dBc	40	45	-
552.0 ~ 656.0 MHz		dBc	40	51	-
656.0 ~946.0 MHz		dBc	30	37	-
Input Return Loss (452.6 ~ 459.4 MHz)		dBc	9.5	13.0	-
Output Return Loss (452.6 ~ 459.4 MHz)		dBc	8.5	13.2	-
Temp Coefficient		ppm/ C ²	-	-0.036	-

456.0MHz SAW Filter
Part No: MP01133

Model: TB0574A
REV NO: 3

D. FREQUENCY CHARACTERISTICS:

1. Sdd21 Response

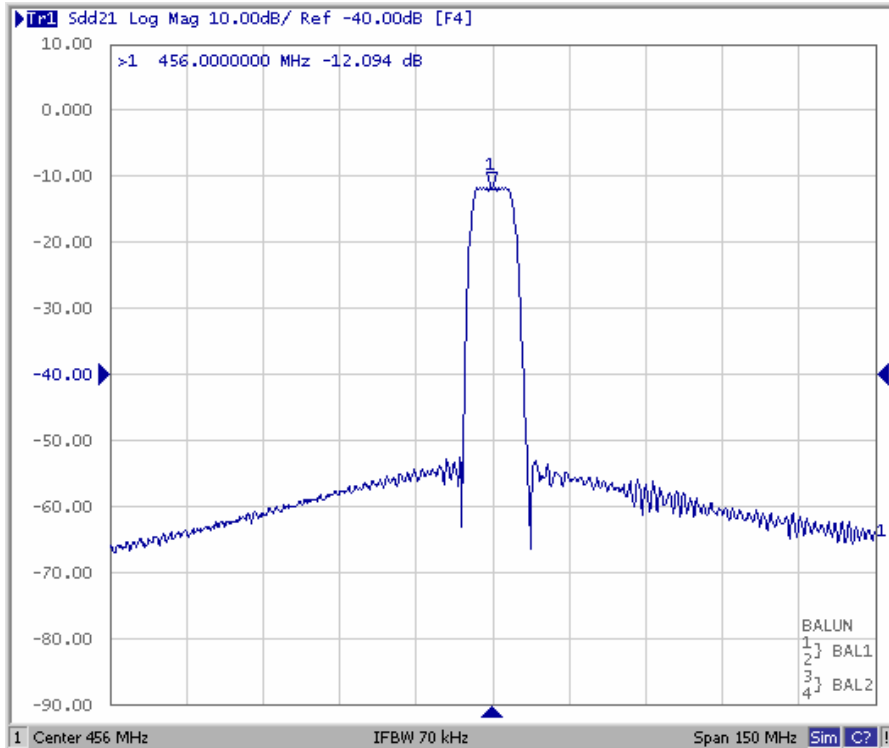

Fig1. Horizontal: 15MHz/Div Vertical: 10dB/Div

2. Passband Ripple

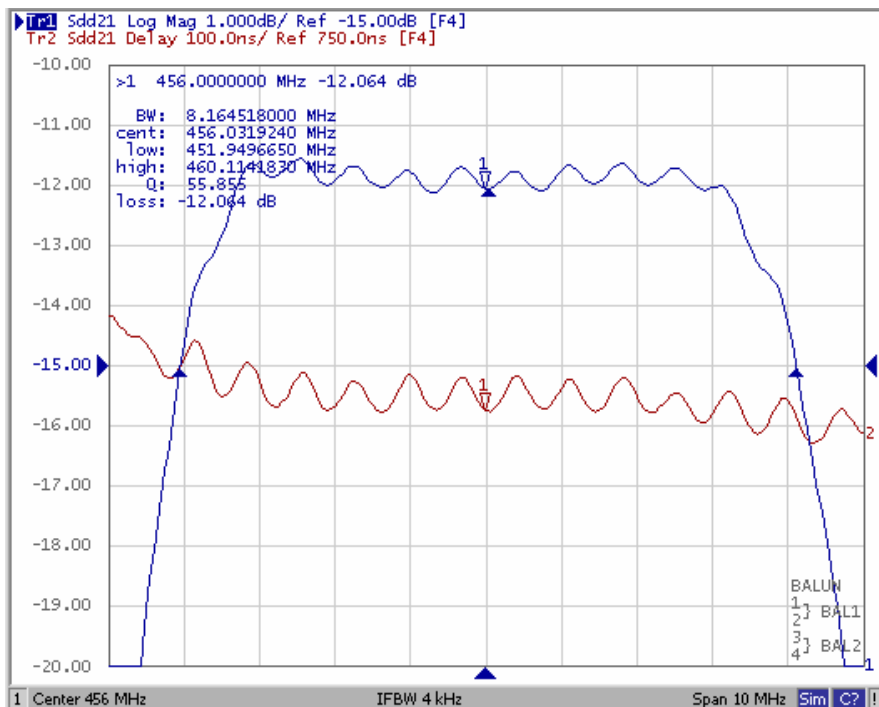
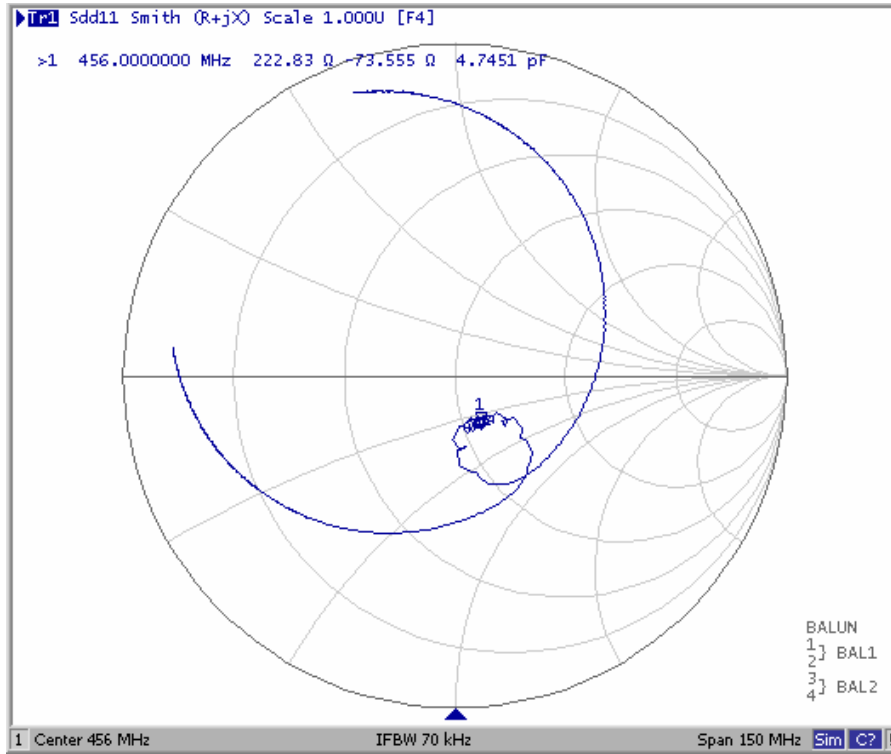

Fig2. Horizontal: 1MHz/Div Vertical: 1dB/Div

456.0MHz SAW Filter
Part No: MP01133

Model: TB0574A
REV NO: 3

3. Sdd11 Smith Chart (span : 150MHz)



4. Wide band Response

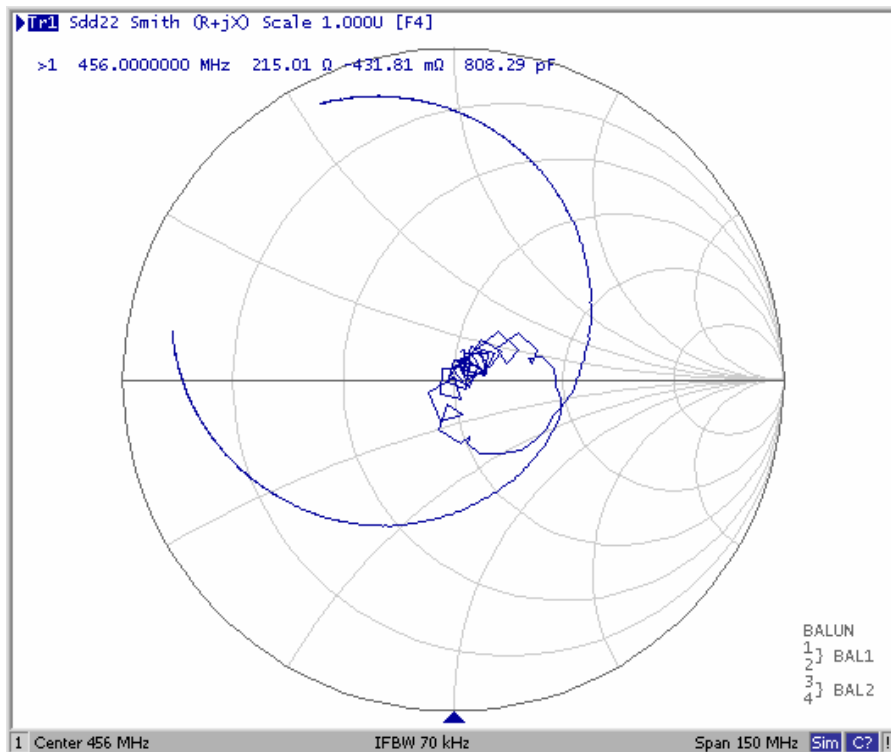

456.0MHz SAW Filter

Model: TB0574A

Part No: MP01133

REV NO: 3

E. MEASUREMENT CIRCUIT

Balanced input 200 ohm to Balanced Output 200 ohm

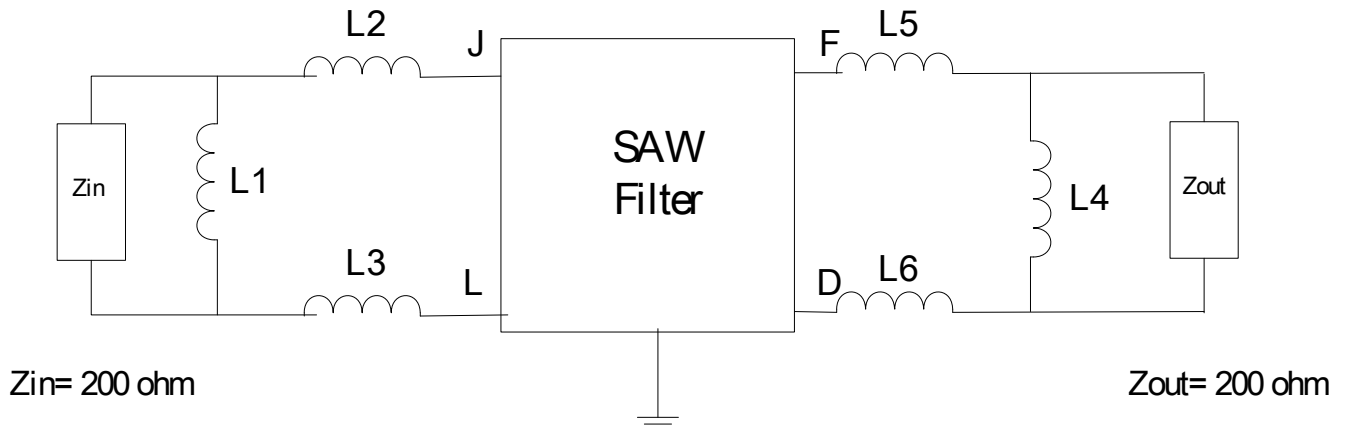

$L1=15\text{nH}$, $L2=L3=5.6\text{nH}$, $L4=15\text{nH}$, $L5=L6=8.2\text{nH}$

F. OUTLINE DRAWING:

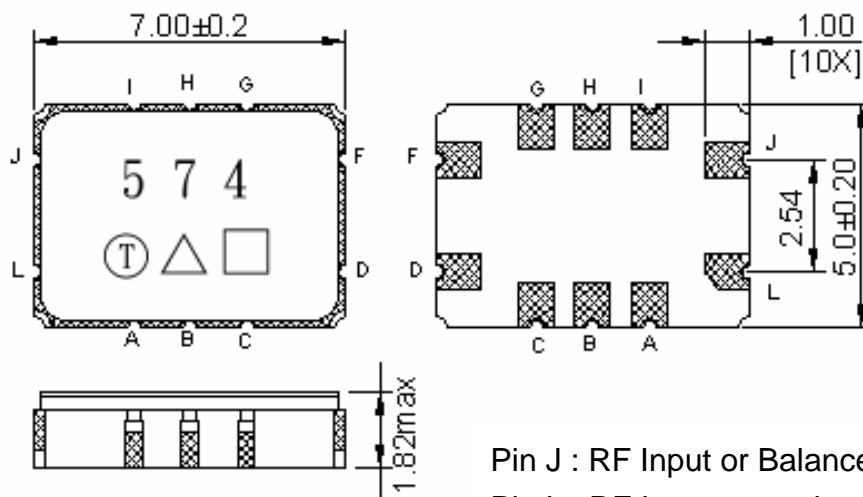

Pin J : RF Input or Balanced Input +
 Pin L : RF Input ground or Balanced input -
 Pin D : RF Output or Balanced Output+
 Pin F : RF Output ground or Balanced Output -
 Pin A,B,C,G,H,I : Ground
 Unit: mm

456.0MHz SAW Filter

Model: TB0574A

Part No: MP01133

REV NO: 3

G. PCB FOOTPRINT

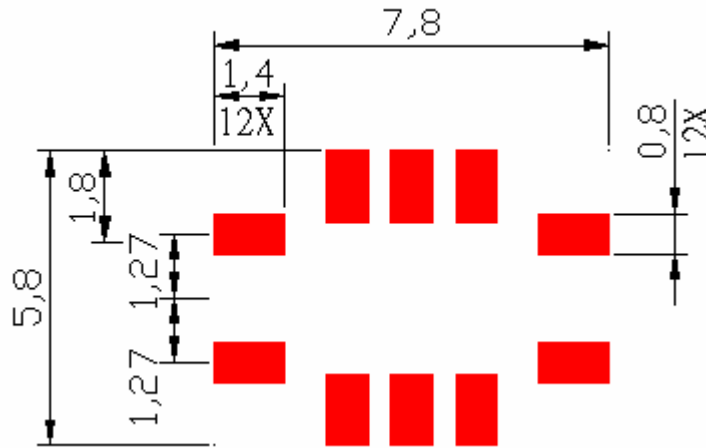

Unit: mm

456.0MHz SAW Filter
Part No: MP01133

Model: TB0574A
REV NO: 3

H. PACKING:

1. REEL DIMENSION

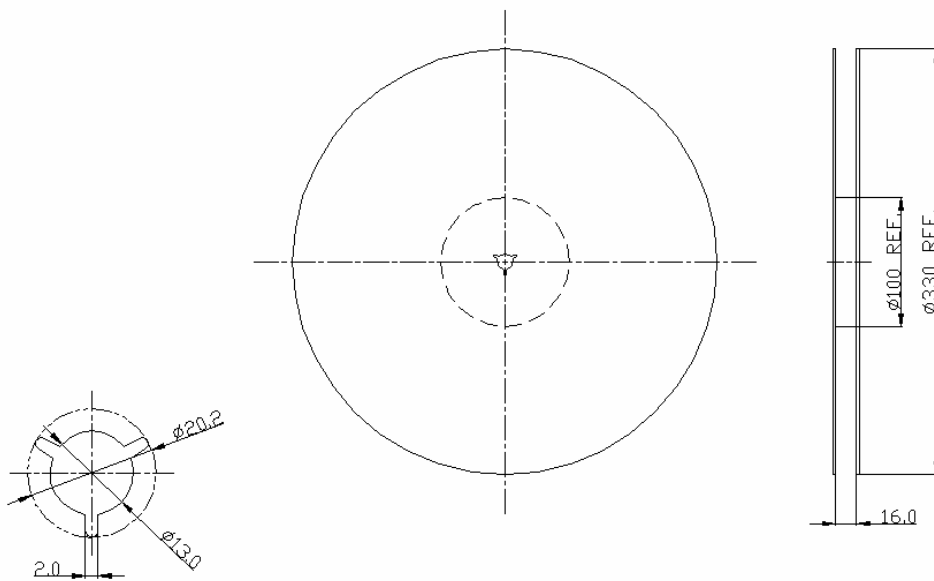

Unit: mm

2. TAPE DIMENSION

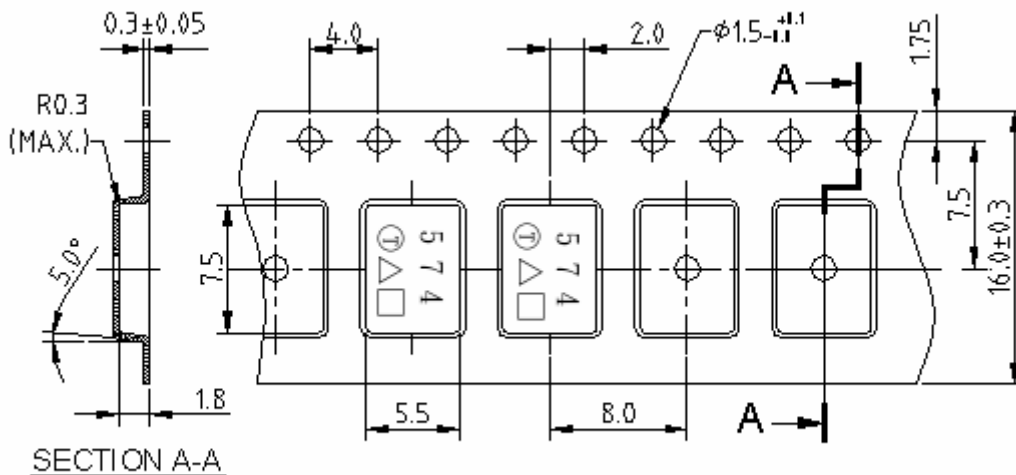

Unit: mm

456.0MHz SAW Filter

Model: TB0574A

Part No: MP01133

REV NO: 3

I. RECOMMENDED REFLOW PROFILE:

